

## Duplexer For BAND1 (1950MHz, 2140MHz)

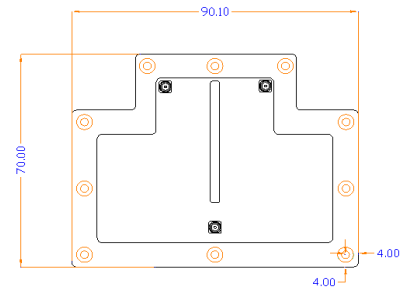
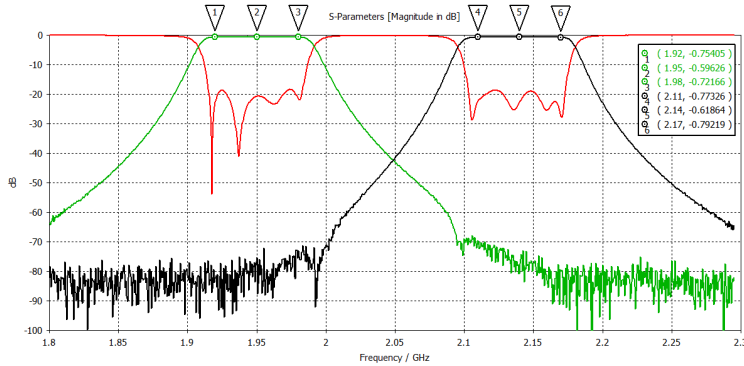

### FEATURES

- Usable Bandwidth 60MHz at Fo 1950MHz & 60MHz at Fo 2140MHz
- 50 ohm Single-ended Operation, **20 Watt Power Handling**
- Surfaced Mounted Module Package (74.2mm × 54.0mm × 6.6mm, < 80 gram)

## Duplexer For BAND3 (1747.5MHz, 1842.5MHz)

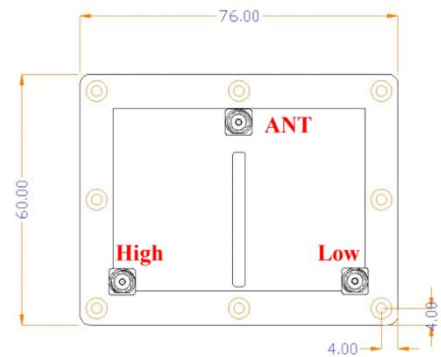
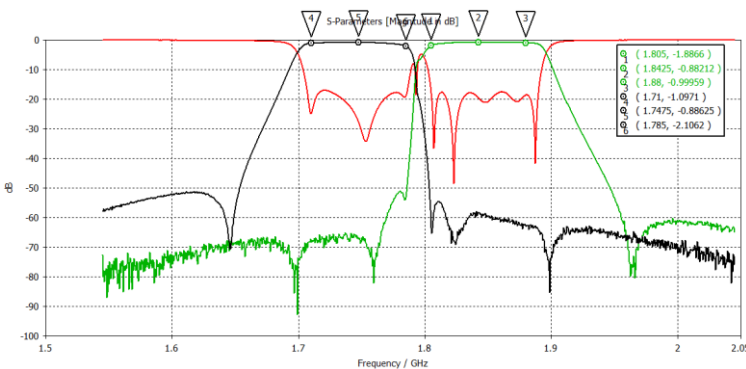

### FEATURES

- Usable Bandwidth 75MHz at Fo 1747.5MHz & 75MHz at Fo 1842.5MHz
- 50 ohm Single-ended Operation, **20 Watt Power Handling**
- Surfaced Mounted Module Package (76.0mm × 60.0mm × 16.0mm, < 70 gram)

## Duplexer For 4460MHz, 4960MHz

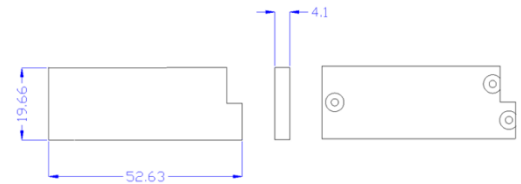
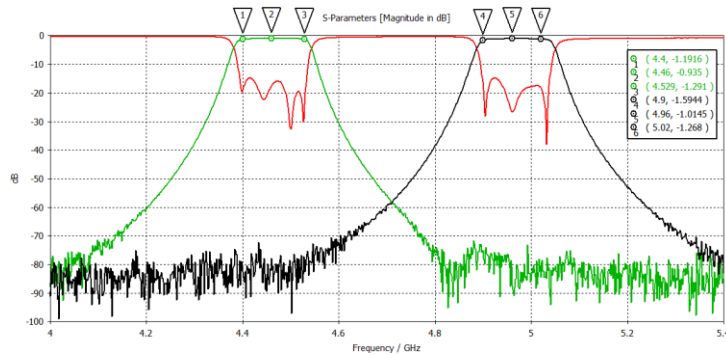

### FEATURES

- Usable Bandwidth 120MHz at Fo 4460MHz & 120MHz at Fo 4960MHz
- 50 ohm Single-ended Operation, 5 Watt Power Handling
- Surfaced Mounted Module Package (52.7mm × 19.7mm × 4.1mm)

## Duplexer For 6675MHz, 7015MHz

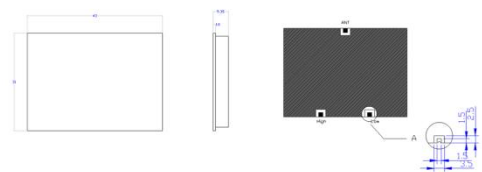
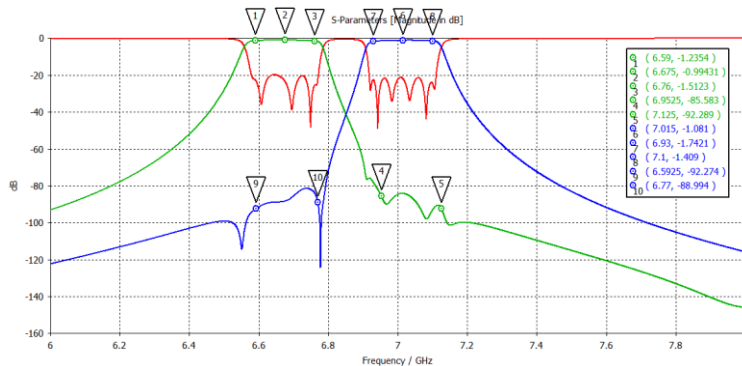

### FEATURES

- Usable Bandwidth 170MHz at Fo 6675MHz & 170MHz at Fo 7015MHz
- 50 ohm Single-ended Operation, 5 Watt Power Handling
- Surfaced Mounted Module Package (43.0mm × 31.0mm × 5.35mm)